



TECHNICAL SPECIFICATIONS

# BESPOKE STEEL DOORS

**WDC SERVICE  
SOLUTIONS LTD**

Complete Door Security  
and Access Solutions



## TECHNICAL SPECIFICATIONS

# BESPOKE STEEL DOORS

### LEAF

45mm thick Door leaf with flush lipped astragal constructed from:  
2 x 1.2mm thick 'Rustec' sheets, which are Dutch folded and internally bonded together.\*

42mm thick 'Hexatex' core.\*

3 year warranty against rust as standard for all colour coated doors.\*

### WEIGHT

31kg/m<sup>2</sup> with Honeycomb core and 35kg/m<sup>2</sup> with Rockwool Core

### FRAME

Manufactured from 1.6 mm thick 'Rustec' steel.\*

Single rebate 104mm wide frame with additional rebate for flush lip.\*

A minimum of six fully adjustable fixing points are provided to each jamb.\*

Unique 'Adjust-2-fit' side channels with each frame.\*

Double rebate frames are available on request.

3 year warranty against rust as standard for all colour coated doors.\*

### DOOR IRONMONGERY

BS 7352 Grade 13 stainless steel, twin bearing template drilled butt hinges with integral high security dog bolts are fitted as standard with CE marking.

### VISION PANELS (OPTIONAL)

20GA Cold Rolled Steel – Stainless Steel available upon request.

Single and Double glazed.

6mm GWPP/ 6.4mm Laminated / 6mm Toughened / 9mm Ceramic.

Obscured and frosted options on request.

22mm Double Glazed units.

For security most doorsets in the range are tested to PAS 24. For air permeability, the standard is BS EN1026:2000 and was passed class 4 – 600Pa (113kmh) test pressure. For weather-tightness, the standard is BS 6375: Part 1: 2009 (test to BS EN1026:2000, BS EN1027:2000, BS EN12211:2000) and Steeldor passed the 1200 exposure rating. For water-tightness, the standard BS EN1027:2000 was passed 150Pa for outward opening and 100Pa for inward opening. For wind load the BS EN12211:2000 standard was passed 1200Pa (Class A3) 98 mph.



### LOUVRES (OPTIONAL)

18GA Galvanised Steel – frame.

22GA Galvanised Steel – louver blades.

50% Free air flow in standard configuration.

Bird Mesh and Insect Mesh available.

36% Free air flow when using insect mesh.

### FINISH

Comes as standard in a powder coated finish in one of our standard colours.

Full range of RAL and BS colours available.

Marine Grade finish is available as an option in salt laden coastal or high chlorination locations.

Full range of finishes available including, metallics and pearlescent.

10 year warranty against rust optional with our 'Colourtec' coating.

### THRESHOLD

Aluminium threshold with neoprene seal on external outward opening doors.

Double ramped threshold available for doors needing pallet truck access. – Require rain-drip & brush seal to prevent water ingress.

Specialist inward opening threshold available where water ingress is an issue on inward opening doors.

### SEALS

Strongdor self adhesive P-seal provided as standard.

### SIDE PANELS & OVER PANELS (OPTIONAL)

Solid, Glazed and Louvred side and over panels available.

*\* Available on most doorsets in the range.*

## WDC SERVICE SOLUTIONS LTD

Complete Door Security and Access Solutions

### Threshold

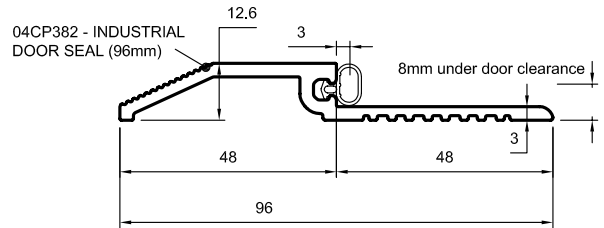

### Frame and Leaf Profile

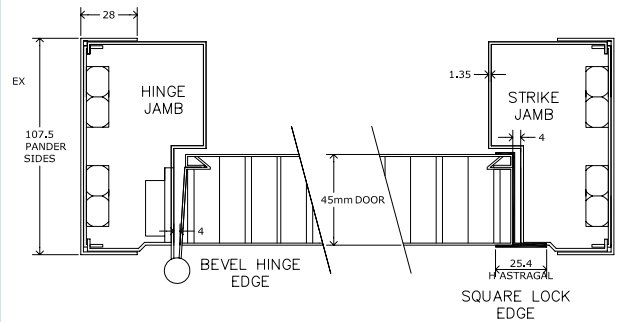

### Vision Panel

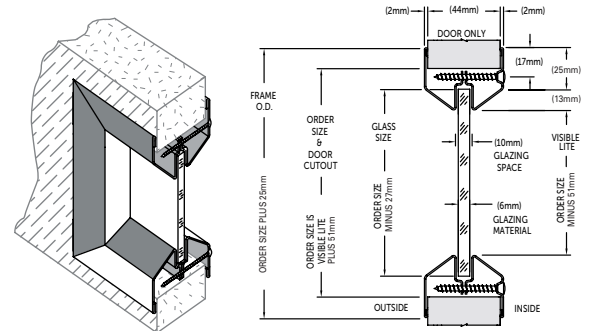

### Louvre Panel

